



HEARTH PRODUCTS

HEARTH PRODUCTS
KITS AND ACCESSORIES

775,257M
Rev. A, 03/2008

LOWER EXTENSION AND SURROUND TRIM
MODELS MEDINA™ AND SDVI

INSTALLATION INSTRUCTIONS FOR INSTALLING THE LOWER EXTENSION AND SURROUND TRIM KIT FOR USE WITH THE MEDINA™ AND SDVI GAS FIREPLACE INSERTS

KIT CONTENTS (See *Figure 1*):

Please ensure that all these parts are in the box

- 1 ea. Lower Extension
- 2 ea. Lower Extension Brackets
- 8 ea. #10-24 Hex Nuts
- 1 ea. Instruction sheet

Note: A side trim kit (P/N 75251), is also required (sold separately). Use a hacksaw, per these instructions, to cut the side trim pieces to the required lengths for your installation.

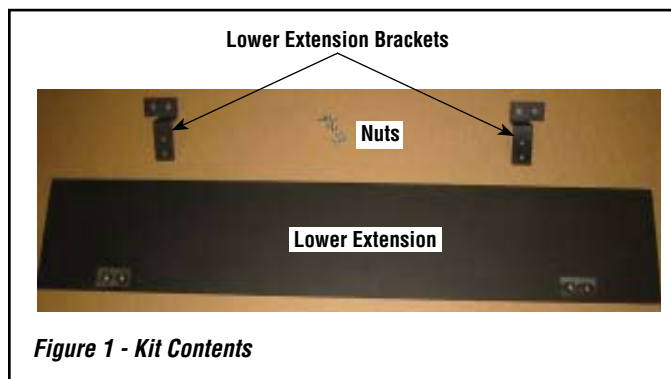

Figure 1 - Kit Contents

TOOLS NEEDED:

- 3/8" Nut Driver
- Hacksaw

GENERAL INFORMATION

When models Medina and SDVI inserts are installed in an elevated factory built fireplace, without a hearth, this lower extension panel will provide a finished look beneath the insert, so the surround will appear finished on all four sides.

If you encounter any problems, need clarification of these instructions or are not qualified to properly install this kit, contact your local distributor or dealer.

Read this instruction sheet in its entirety before beginning the installation.

ALL WARNINGS AND PRECAUTIONS IN THE INSTALLATION AND OPERATION MANUAL PROVIDED WITH THE APPLIANCE APPLY TO THESE INSTRUCTIONS.

TURN OFF THE FIREPLACE INSERT AND ALLOW IT TO COMPLETELY COOL BEFORE PROCEEDING.

INSTALLATION INSTRUCTIONS

Step 1. Using a 3/8" Nut Driver and four #10-24 nuts (provided), install the lower extension brackets onto the lower extension. See *Figure 2*.

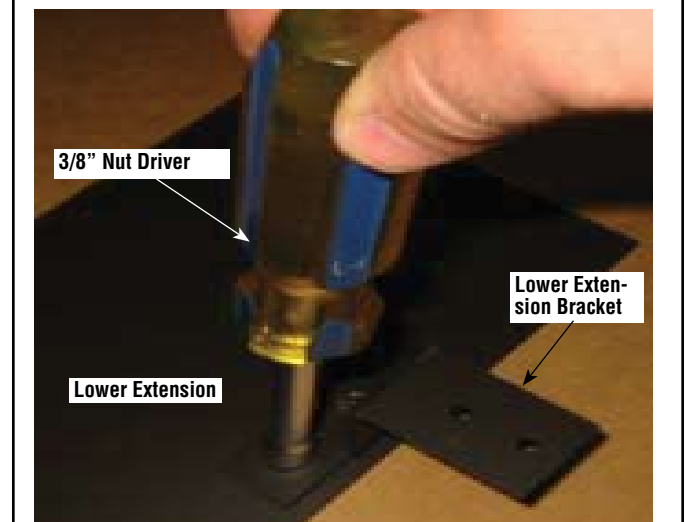
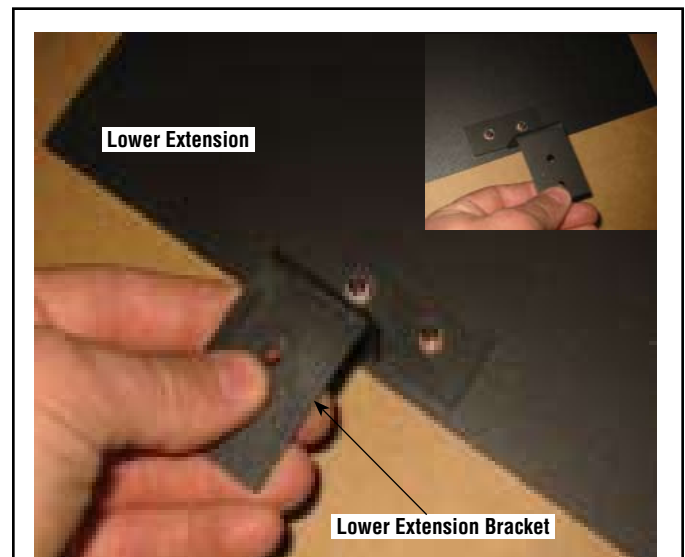

Figure 2 - Install Lower Extension Brackets

Step 2 Using a 3/8" nut driver and four #10-24 nuts (provided), install the lower extension with the brackets attached on the leveling legs (see **Figures 3, 4 and 5**).

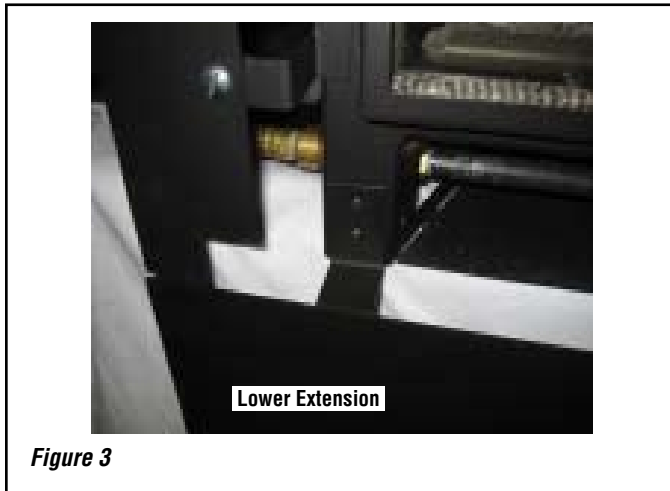

Figure 3



Figure 4



Figure 5

Step 3 The surround trim comes in oversized, so you will need to cut it to the right length using a hacksaw (see **Figure 6**).



Figure 6

Step 4 Assemble the surround trim by inserting the elbowed retainer in the rectangular slot in the ends of the longest piece of trim and secure by tightening the screw in the retainer. Slide the mitred ends of the two side trim pieces onto the elbowed retainer and secure by tightening the retainer screw.

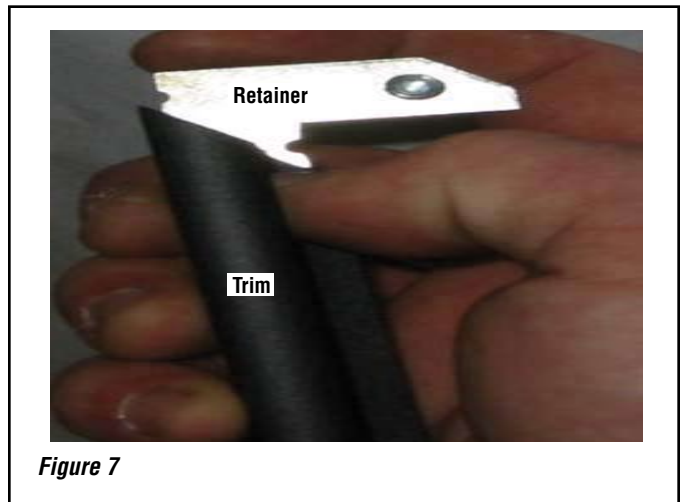

Figure 7

Step 5 The fastened trim pieces should now be horseshoe shaped. Slide the trim down over the surround panels so the edge of the surround fits just behind the rounded edge of the trim.

Step 6 Install four spring clips (found in the parts bag in the firebox) in each piece of trim by inserting them between the rear of the surround and the channel of the trim. The spring clips will push the trim tight to the surround.

NOTE: DIAGRAMS AND ILLUSTRATIONS ARE NOT TO SCALE.

Lennox reserves the right to make changes at any time, without notice, in design, materials, specifications, prices and also to discontinue colors, styles and products. Consult your local distributor for fireplace code information.



HEARTH PRODUCTS

1110 West Taft Avenue • Orange, CA 92865