

INSTALLATION INSTRUCTIONS

For The Vent-Free Option Series Refractory Liner Kits

Models
_GASVF-36
_GASVF-36-2
_VF-5
_VF-6

Designed For Use With
Vent-Free
Gas Appliances

One of the most beautiful enhancements you can make to your appliance is the addition of refractory liners.

These refractory liner kits include ceramic fiber panels for placement against the rear and side walls of the firebox. Installation of the panels is quick and easy, simply place them in position against the firebox walls. These kits can be retrofitted into previously installed appliances.

The refractory liner kits described in this document contain all the components necessary to complete the task.

It is recommended that the installation manual provided with the appliance be read completely and understood thoroughly before proceeding with the installation of the kit. All warnings and precautions in that document apply to these instructions.

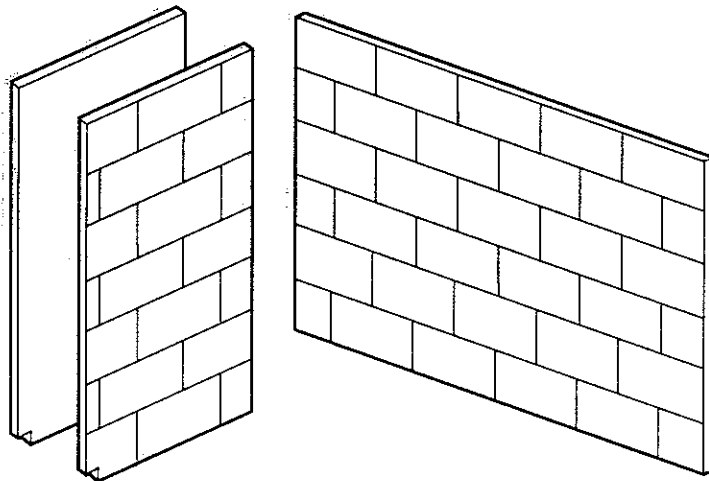

INSTALLATION

Step 1. Turn off the gas supply to the appliance. Allow the appliance to cool to room temperature. Remove the front door frame assembly from the appliance. If pull screens are used, push the screen panels to the left and right.

Step 2. Carefully remove the smaller twigs. Then remove the main logs. Exercise care as not to break the logs.

Step 3. Clean the firebox walls thoroughly with a cloth dampened with clean water. **Do not use any form of chemical cleaner.**

Step 4. Position the rear refractory panel against the rear firebox wall. Hold in place with one hand. Secure panel in place with bracket and screw as shown in *Figure 1*.

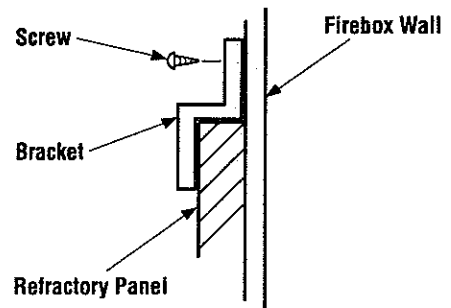

Figure 1

Step 5. Place one of the side refractory panels in position against the firebox side wall. When properly positioned the side refractory panel is firmly held in place by a snug fit developed between the firebox side wall front edge and the rear refractory panel. Secure with bracket and screw as in Step 4.

Step 6. Position the other refractory side panel in a similar fashion.

Step 7. Reposition the logs and reinstall the front door frame assembly.

Note: Underscore is used here in place of a letter character which varies by product line. Letter shown in the first position of the Model Number is designated as follows: S = Superior, F = Fireplus, H = Hearthstar

NOTE: DIAGRAMS & ILLUSTRATIONS NOT TO SCALE.

SFC reserves the right to make changes at any time, without notice, in design, materials, specifications, prices and also to discontinue colors, styles and products. Consult your local distributor for fireplace code information.

Printed in U.S.A. © 1996 by SFC
P/N 903408 REV. A 4/97

SFC

4325 Artesia Avenue • Fullerton, CA 92833
714-521-7302
503 East Reelfoot Avenue • Union City, TN 38261
901-885-7621